

WESERTAL

Erschließungsgesellschaft mbH

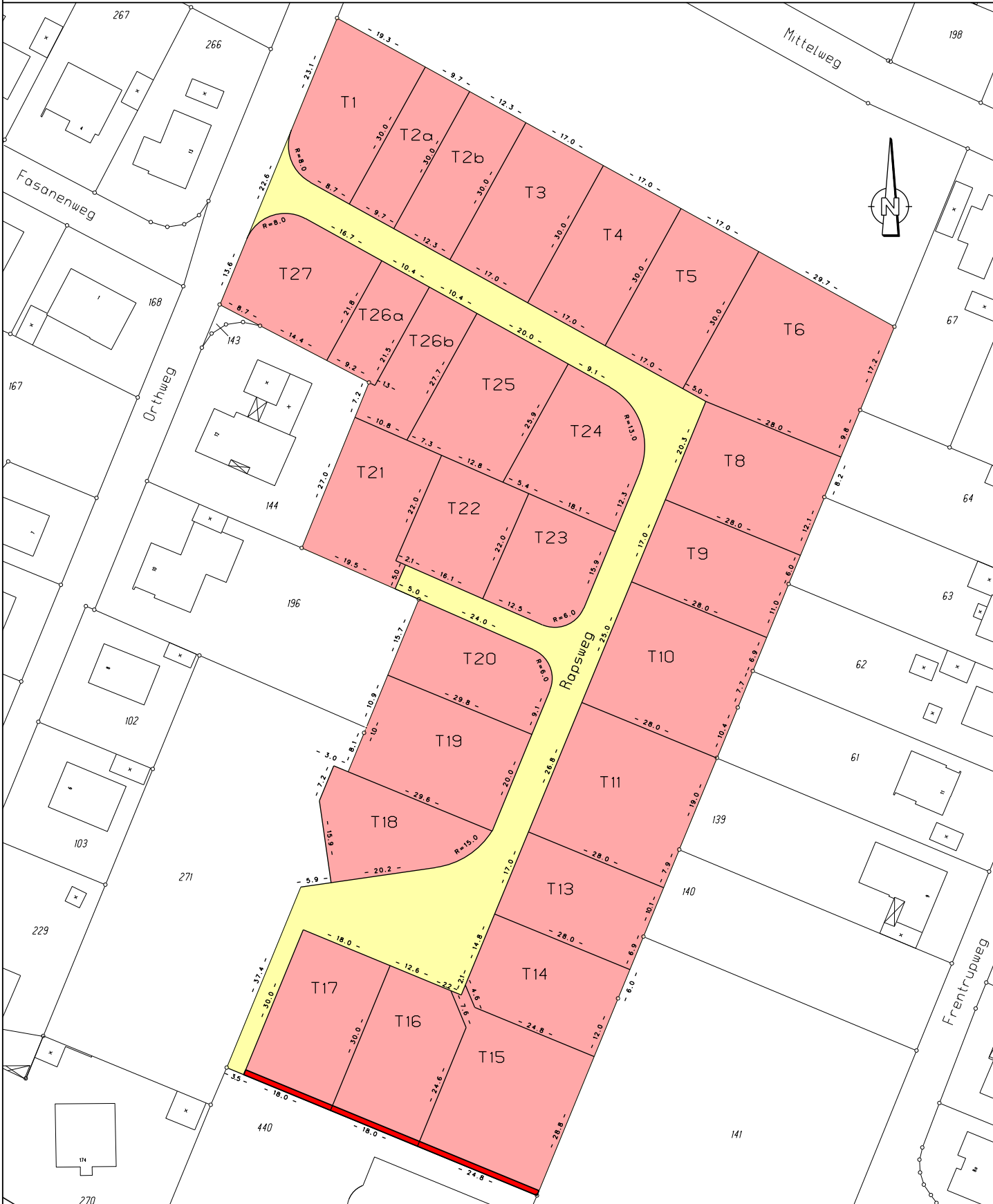

Bebauungsplangebiet Nr. 8.69 "Orthweg" in Herford

<div style="display: flex; flex-direction: column; gap: 10px;"> <div style="display: flex; align-items: center;"> <div style="width: 20px; height: 20px; background-color: #90EE90; border: 1px solid black; margin-right: 5px;"></div> <p>Freies Grundstück</p> </div> <div style="display: flex; align-items: center;"> <div style="width: 20px; height: 20px; background-color: #FFC0CB; border: 1px solid black; margin-right: 5px;"></div> <p>Verkauftes Grundstück</p> </div> </div>	<div style="display: flex; flex-direction: column; gap: 10px;"> <div style="display: flex; align-items: center;"> <div style="width: 20px; height: 20px; background-color: #FFD700; border: 1px solid black; margin-right: 5px;"></div> <p>Verkehrsfläche</p> </div> </div>	<div style="display: flex; flex-direction: column; gap: 10px;"> <div style="display: flex; align-items: center;"> <div style="width: 20px; border-bottom: 1px solid black; margin-right: 5px;"></div> <p>Feste Grenzen</p> </div> <div style="display: flex; align-items: center;"> <div style="width: 20px; border-bottom: 1px dotted black; margin-right: 5px;"></div> <p>Variable Grenzen</p> </div> <div style="display: flex; align-items: center;"> <div style="width: 20px; border-bottom: 3px solid red; margin-right: 5px;"></div> <p>Lärmschutzzaun, H=2m</p> </div> </div>
Bearbeitungsstand: 22.03.2010		